

**MP 10.4 38' Deck Plate Girder Concrete Deck**

**Mile 9.4 Trail MP 8.4 Over Montour Run at Imperial**

Along Station Street & opposite Patterson Avenue

Looking south from Station Street side – 1928 in concrete deck. No Builder's Plate, but probably a McClintic-Marshall Co. bridge, installed during realignment of main line. Railings and fences installed as bridge converted for Trail use.



2010 photos Bryan Seip

Looking north from Patterson Avenue – 1928 in concrete deck





Valuation Plan shows bridge and abutments to upper left of center. Note indication of Old Channel of Montour Run and Channel Change at circle # 40B at top left of picture. Stream was relocated when the bridge was installed. North is at left of picture. Building to left of bridge is marked Federal Supply Co. Findlay Township Community Building is now at lower left, where word "Imperial" is shown beside tracks. Road running along lower left edge of picture is Main Street.

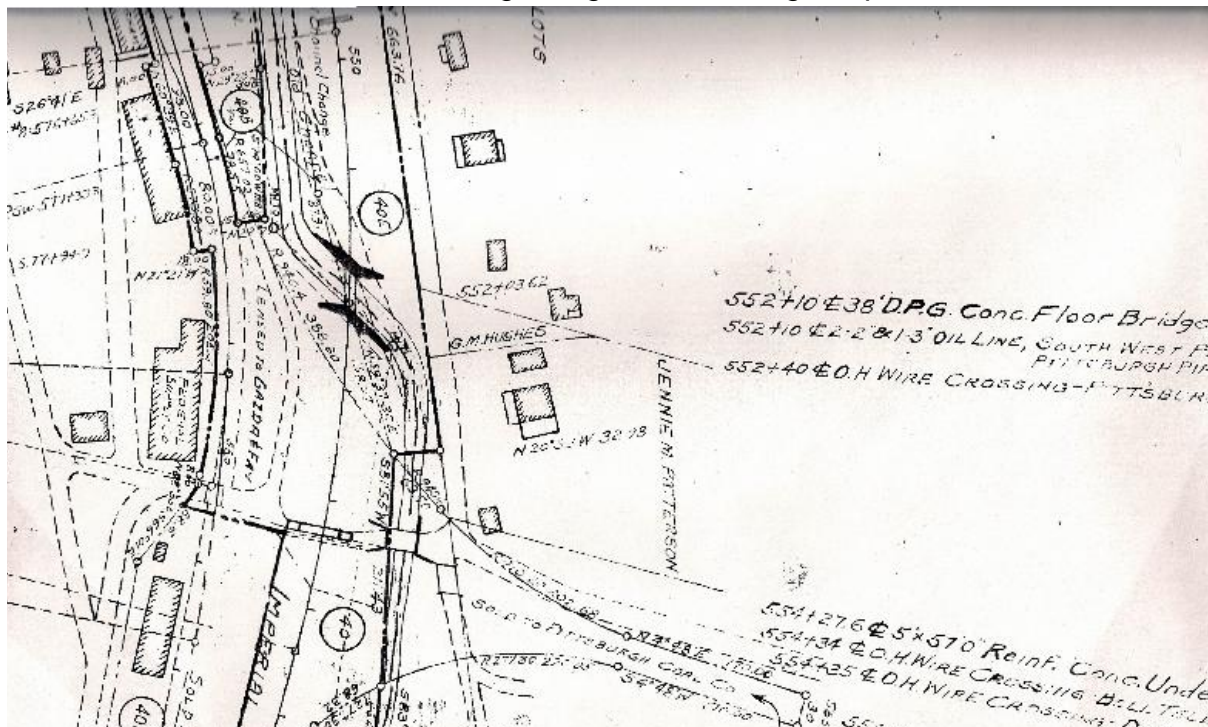

Courtesy Greg Corcoran

Satellite view shows bridge at bottom center, behind former Federal Supply Co. building. Findlay Township Community Center is at left side of picture, former lumber yard at upper right. Main Street runs across top of picture, Patterson Street at lower right. The original main line ran through the lumber yard, past Federal Supply and through the area which is now the Community Center and parking lot.



Google Images

Topo map shows bridge crossing the stream just below center. Main Street runs across picture, while road in red on left side is Rt. 30. Spur with double track indicated is the original main line.

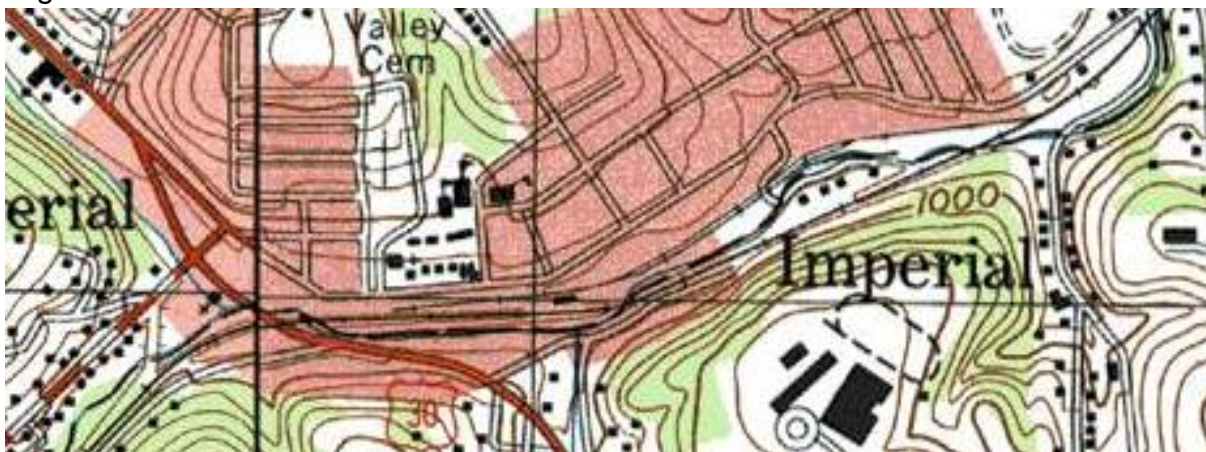

Courtesy Bob Ciminel